

Dimensions			
Pos.	A	B	C
06	11.14	4.00	5.00
08	13.14	6.00	7.00
10	15.14	8.00	9.00
12	17.14	10.00	11.00
14	19.14	12.00	13.00
16	21.14	14.00	15.00
18	23.14	16.00	17.00
20	25.14	18.00	19.00
22	27.14	20.00	21.00
24	29.14	22.00	23.00
26	31.14	24.00	25.00
28	33.14	26.00	27.00
30	35.14	28.00	29.00
34	39.14	32.00	33.00
36	41.14	34.00	35.00
38	43.14	36.00	37.00
40	45.14	38.00	39.00
44	49.14	42.00	43.00
48	53.14	46.00	47.00
50	55.14	48.00	49.00
60	65.14	58.00	59.00
64	69.14	62.00	63.00

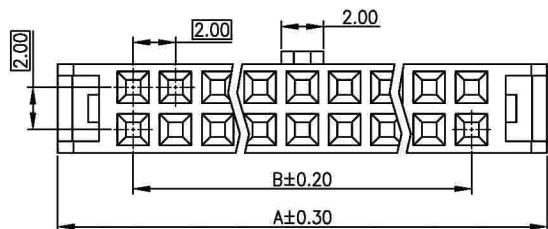
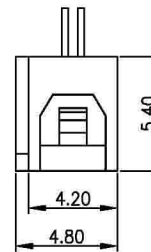
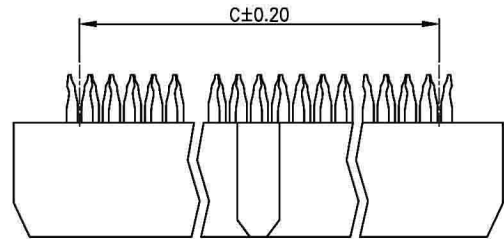
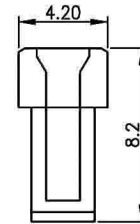
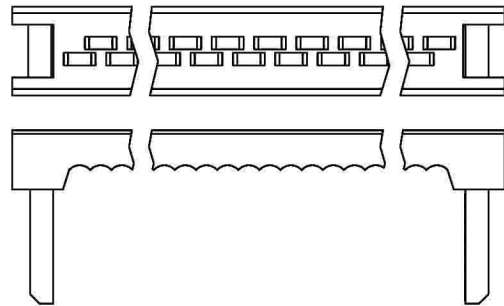
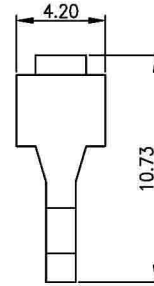
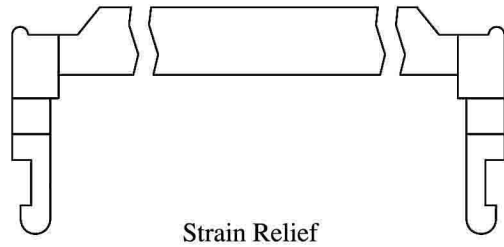

RoHS COMPLIANT

REV	ECN NO.	DESCRIPTION	DATE
A		RELEASE	OCT.26.06
B		MODIFY P/N	OCT. 12'09
C		MODIFY P/N	APR. 29'11

Material and Finish

1. Housing: PBT (UL94V-0), Black.
2. Terminal: Copper Alloy (t=0.30mm), Gold Plating on Contact Area, Nickel Plating on Insulation Pierce Area.

Electrical Characteristics

1. Current Rating: 1.0 Amp. Max..
2. Dielectric Withstand Voltage: 500V AC RMS for 60Seconds.
3. Insulation Resistance: 1000M Ohms Min. at 500V DC.
4. Contact Resistance: 30m Ohms Max.

Mechanical Characteristics

1. Operating Temperature: -40°C ~ +105°C

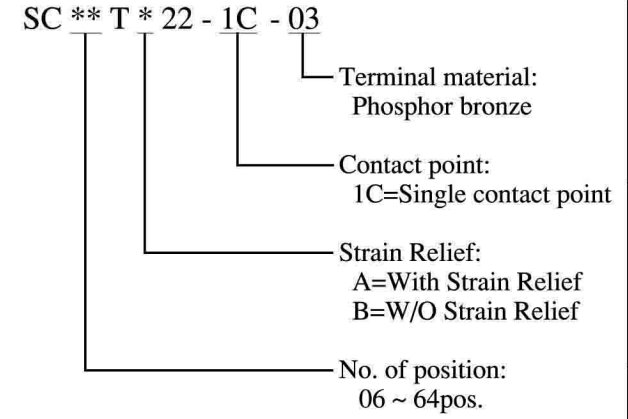

TOLERANCE UNLESS OTHERWISE SPECIFIED		PROJECTION	GOLD-TEK ELECTRIC CO., LTD.	
LINEAR	ANGLE	UNITS	TITLE	PART NO.
X. ± 0.30	X° ± 1°		2.0mm IDC SOCKET	SC**T*22-1C-03
.XX ± 0.20	.XX° ±	SCALE	CAD NO. I627	SHEET
.XXX ± 0.10	.XXX° ±		CPART NO	F:PDF/SOC/SOC-0547
APPD		SIZE	圖面編號:GTKSD2006-C(1)	
CHKD				
DRAW	Z			
	APR.29'2011			