

RML-37 Series

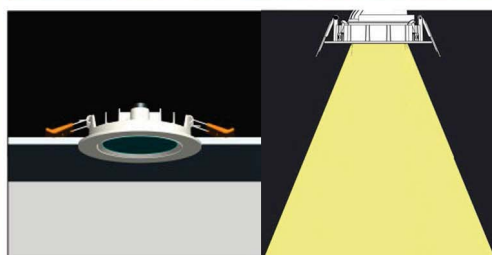

Product features



Outer ring: GB 12# environmental-friendly aluminum is adopted and is overall die-cast to take shape, with beautiful structural design.



Reflective sheeting: the Hp LCD TV backlight reflective sheeting has superstrong light reflection, with thickness of 0.25mm-0.5mm.



Diffuser plate: PS material from Japan Mitsubishi is used. The 1.5mm ultrathin diffuser plate has a light transmittance of up to 92%, and its even and gentle light diffusion can effectively reduce fatigue and create the healthy light environment.



Aluminum substrate: high-conductivity aluminum is used to accelerate heat dissipation.



Rear cover: GB 12# environmental-friendly aluminum is adopted and is overall die-cast to take shape. This kind of aluminum is more environmental-friendly and durable, and has more strength and malleability than those of normal aluminum material. The arc design of the back can accelerate air convection and greatly enhance heat dissipation effect.



Power line: silica gel is used externally, and it has the joint lock ring design which is easy for installation and disassembly. Pure copper core line is used internally, which has a small resistance, with resistance to bend, flame retardancy, and resistance to high temperature and aging.



Plate spring: it is made of the superior stainless steel, with strong elasticity, accurate bending angle and corrosion resistance, which is not easy to damage and is high in use security.



I-shaped protective ring: to protect the friction between the power line and the base and avoid damage of the power line.



Driver: low-voltage constant-current intelligent IC driver is used, which is of integrated design and made of the imported PC material, with dust prevention, compression resistance and high temperature resistance. Ambient temperature for working: -20°C-85°C

Wire clip of panel light: to better fix the power line and fasten it to avoid coming off.

RML-37 Series

Applications

- Convention Center
- Hotels
- Boutiques
- Bussiness Center
- Museums
- Home
- Offices
- Hospitals
- Leisure Space. Etc



Part number system

RML- 37 - R - 6W - 30K
 X1 X2 X3 X4

X1=Series

X2=Shape

R=Round type

S=Square type

X3=Rate Power

6W=6 Watts

12W=12 Watts

18W=18 Watts

X4=Color temperature

30K=3000K

40K=4000K

60K=6000K

Dimensions

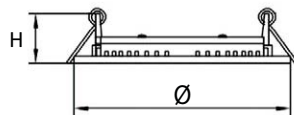
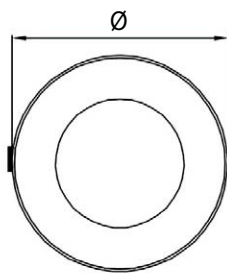

Cut-Out



Hole Dimension

Specifications

Specifications RML-37 ROUND

Power factor.	≥0.5
Power-Supply Efficiency	≥88%
Color rendering index	RA≥80
Using Temperature	-20°C - 50°C
LED Maker	SANAN
View Angle	35°

RML-37 Series

Illuminance for different color

Rated Power	Part No.	Luminous Flux	Color of light	Color temperature	Input	Dimension	Hole Dimension	size
6W	RML-37-R-6W-30K	450-510 Lm	Warm White	3000 K	20-24VDC 300mA	φ85 x 26mm.	φ75mm.	3 inch
	RML-37-R-6W-40K		Neutral White	4000 K				
	RML-37-R-6W-60K		Daylight	6000 K				
12W	RML-37-R-12W-30K	960-1020 Lm	Warm White	3000 K	36-40VDC 300mA	φ125 x 29mm.	φ110mm.	4 inch
	RML-37-R-12W-40K		Neutral White	4000 K				
	RML-37-R-12W-60K		Daylight	6000 K				