

# RML-12 Series



## Product features



**Outer ring:** GB 12# environmental-friendly aluminum is adopted and is overall die-cast to take shape, with beautiful structural design.



**Reflective sheeting:** the Hp LCD TV backlight reflective sheeting has superstrong light reflection, with thickness of 0.25mm-0.5mm.



**Diffuser plate:** PS material from Japan Mitsubishi is used. The 1.5mm ultrathin diffuser plate has a light transmittance of up to 92%, and its even and gentle light diffusion can effectively reduce fatigue and create the healthy light environment.



**Aluminum substrate:** high-conductivity aluminum is used to accelerate heat dissipation.



**Rear cover:** GB 12# environmental-friendly aluminum is adopted and is overall die-cast to take shape. This kind of aluminum is more environmental-friendly and durable, and has more strength and malleability than those of normal aluminum material. The arc design of the back can accelerate air convection and greatly enhance heat dissipation effect.



**Power line:** silica gel is used externally, and it has the joint lock ring design which is easy for installation and disassembly. Pure copper core line is used internally, which has a small resistance, with resistance to bend, flame retardancy, and resistance to high temperature and aging.



**Plate spring:** it is made of the superior stainless steel, with strong elasticity, accurate bending angle and corrosion resistance, which is not easy to damage and is high in use security.



**I-shaped protective ring:** to protect the friction between the power line and the base and avoid damage of the power line.



**Driver:** low-voltage constant-current intelligent IC driver is used, which is of integrated design and made of the imported PC material, with dust prevention, compression resistance and high temperature resistance. Ambient temperature for working: -20°C-85°C

**Wire clip of panel light:** to better fix the power line and fasten it to avoid coming off.

# RML-12 Series

## Applications

- Convention Center
- Hotels
- Boutiques
- Bussiness Center
- Museums
- Home
- Offices
- Hospitals
- Leisure Space. Etc

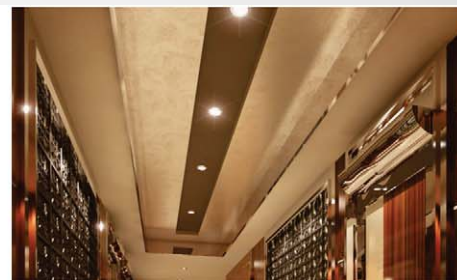

## Part number system

RML-12 - DL R - 15W - 30K  
X1 X2 X3 X4 X5

**X1=Series**

**X2=Product type**

DL=Down light

SPL=Surface-Mount Downlight

PL=Panel light

**X3=Shape**

R=Round type

SQ=Square type

**X4=Rate Power**

5W=5 Watts

10W=10 Watts

15W=15 Watts

22W=22 Watts

30W=30 Watts

**X5=Color temperature**

30K=3000K

40K=4000K

65K=6500K

## Dimensions

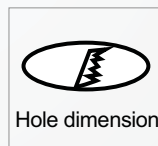
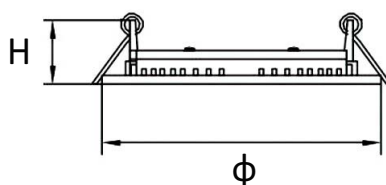
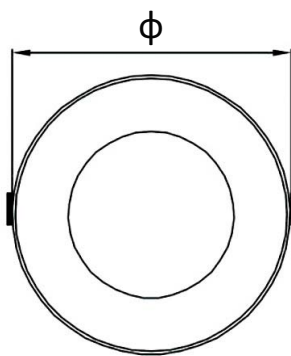

# RML-12 Series

## Specifications

Power factor:	≥0.9
Power-Supply Efficiency:	≥88%
Color rendering index:	RA≥75
Using Temperature:	-20°C - 50°C
View angle :	120 °

Rated Power	Part No.	Luminous Flux	Color of light	Color temperature	Current	Dimensions (φxH)	Hole dimension	size
10W	RML-12-DLR-10W-30K	700-750 Lm	Warm White	3000 K	300 mA/ 25-45 Vdc	φ108x29 mm.	φ90 mm	3.5 inch
	RML-12-DLR-10W-40K		Neutral White	4000 K				
	RML-12-DLR-10W-65K		Daylight	6500 K				
15W	RML-12-DLR-15W-30K	1250-1350 Lm	Warm White	3000 K	300 mA/ 45-80 Vdc	φ148x29 mm.	φ130 mm	5 inch
	RML-12-DLR-15W-40K		Neutral White	4000 K				
	RML-12-DLR-15W-65K		Daylight	6500 K				
22W	RML-12-DLR-22W-30K	1900-2100 Lm	Warm White	3000 K	600 mA/ 25-45 Vdc	φ200x29 mm.	φ175 mm	6.5 inch
	RML-12-DLR-22W-40K		Neutral White	4000 K				
	RML-12-DLR-22W-65K		Daylight	6500 K				
30W	RML-12-DLR-30W-30K	2800-3000 Lm	Warm White	3000 K	700 mA/ 30-50 Vdc	φ245x29 mm.	φ220 mm	8.5 inch
	RML-12-DLR-30W-40K		Neutral White	4000 K				
	RML-12-DLR-30W-65K		Daylight	6500 K				