

Waterproof Connector Installation Instructions

● Cautions before Installation:

1. Please read this manual carefully before install and strictly observe operating instructions.
2. It is suitable for all the floodlights.
3. While connector mounting or disassembly to repair, please ensure to disconnect the power supply.

● Specifications

Connection mode: quick pull plug connection.

IP Rate: IP65.

Cable Diameter: $\Phi 7.0\text{mm}$ or $\Phi 8.9\text{mm}$.

Wiring Method: Free soldering.

● BOM

Housing: PA66 + ferromanganese

Screw: Nickel-plated stainless steel

Waterproof ring: Silicone

● Dimension Drawing

(Unit:mm)

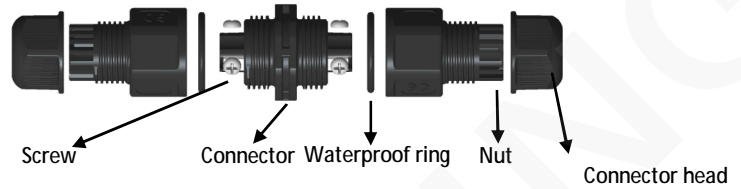
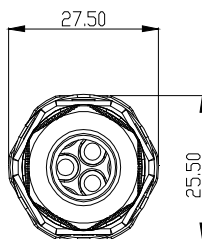
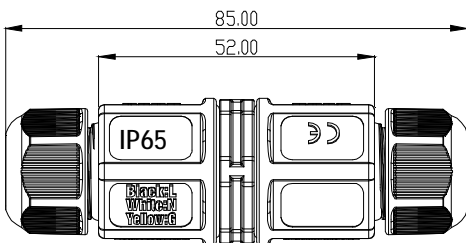

Wiring Method

1. Golden hardware to connect grounding wire- Yellow/green.
2. Gray hardware parts to connect Null line—Blue.
3. Black hardware connect Live wire - - Brown.
4. First, fasten the nut, then the Connector head

Warning

1. All the screws must be locked, Any loose is not permitted
2. Screw up the nuts until press to the waterproof ring. Connector head must be locked, any loose are not permitted.

● Installation diagram

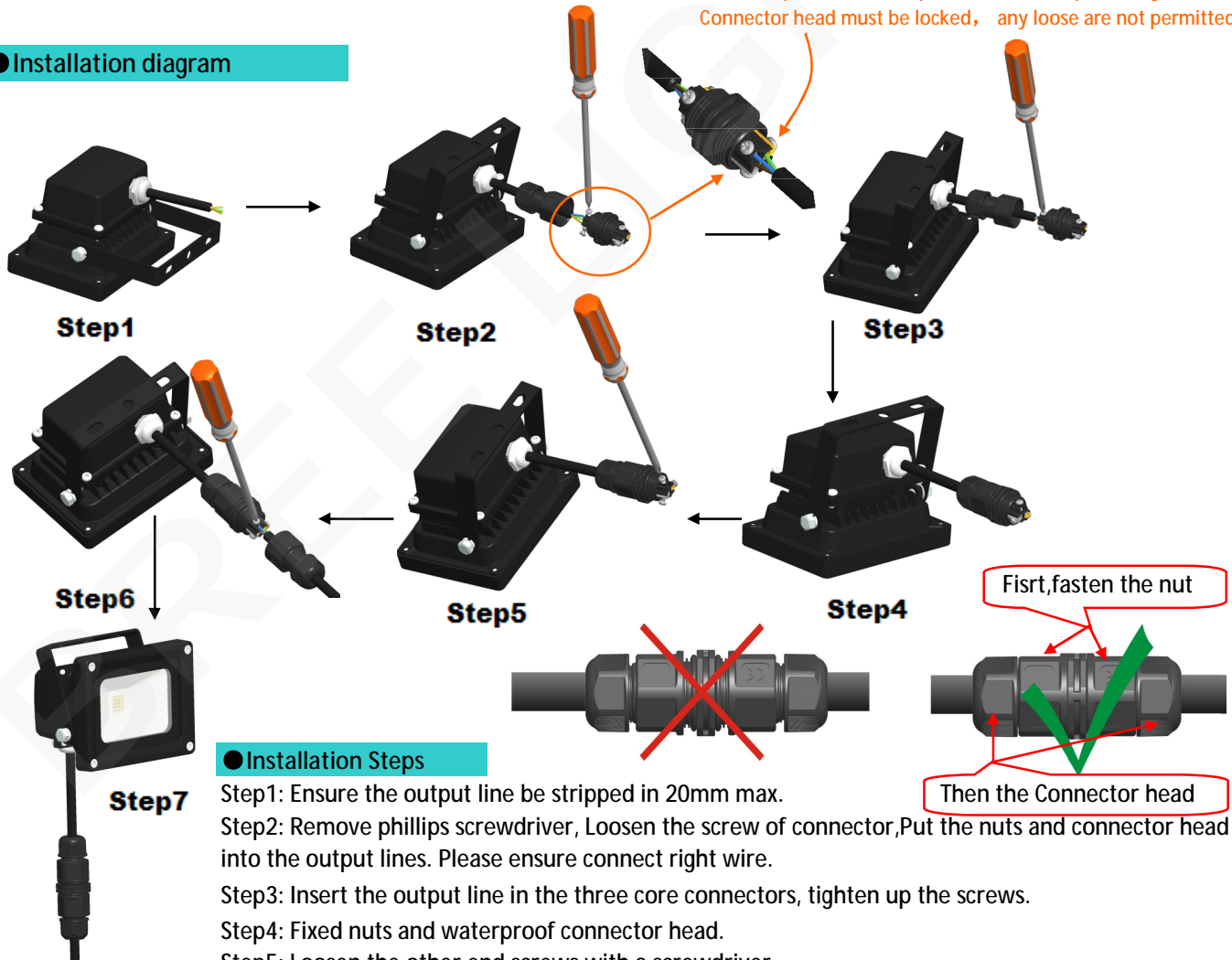

● Installation Steps

- Step1: Ensure the output line be stripped in 20mm max.
- Step2: Remove phillips screwdriver, Loosen the screw of connector, Put the nuts and connector head into the output lines. Please ensure connect right wire.
- Step3: Insert the output line in the three core connectors, tighten up the screws.
- Step4: Fixed nuts and waterproof connector head.
- Step5: Loosen the other end screws with a screwdriver.
- Step6: Insert the output line in the three core connectors, tighten up the screws.
- Step7: Fixed nuts and waterproof connector head, check whether the circuit is connected correctly, power on and light up the floodlights.