

A

B

C

D

E

F

G

H

TRE-280SA VIBRATION MOTOR

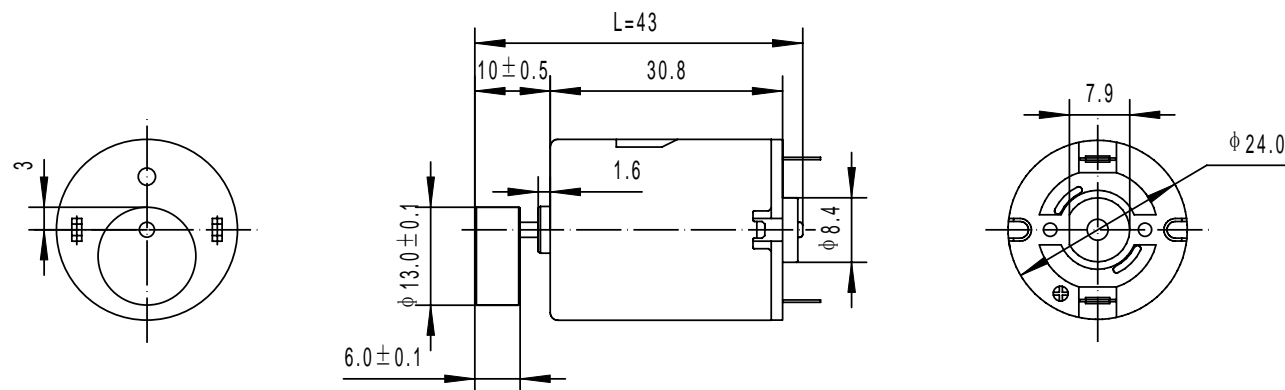

MOTOR Specification(For Reference):

Operation voltage:12.0V DC

Rated Load: $\phi 13 \times 6$ mm Eccentric Weight

1、 Load Speed: $4150 \pm 10\%$ rpm

2、 load current:50mA(100mA)

TITLE:TRE-280SA VIBRATION MOTOR	Customer No: ES	Drafted By: kevin	
		Checked By:	
Dwg. NO: 10440-001	Date: 2011.04.08	Approved By:	
		Scale: 1:1	Units: mm
TT MOTOR (HK) INDUSTRIAL CO.,LTD		EDITION No: A	
		Angular: =1° Decimal: X.XX ±0.05	
		X.X ±0.2	
		X ±0.3	