

## ST-1101D/ST-1202D SMOKE PURIFY MACHINE

- Communication on-line function
- Brushless fan
- Filter element blockage alarm
- Inductive touch button
- Remote control
- Noise reduction design
- Quick replacement of three filters



Item No	ST-1101D	ST-1202D
Voltage	230V	230V
Power	160W	180W
Work positions	1 Workplaces	2 Workplaces
Air Flow	240m <sup>3</sup> /H (±10%)	150m <sup>3</sup> /H*2 (±10%)
Filtration efficiency (0.3micron)	99.97%	99.97%
Dimension	465x250x480mm	465x250x480mm
N.W.	17kg	18.2kg



### Communication on-line function

The fume extractor can be controlled by computer through connecting RS485 interface, can also be connected to the soldering station/hot air station for operation commands.

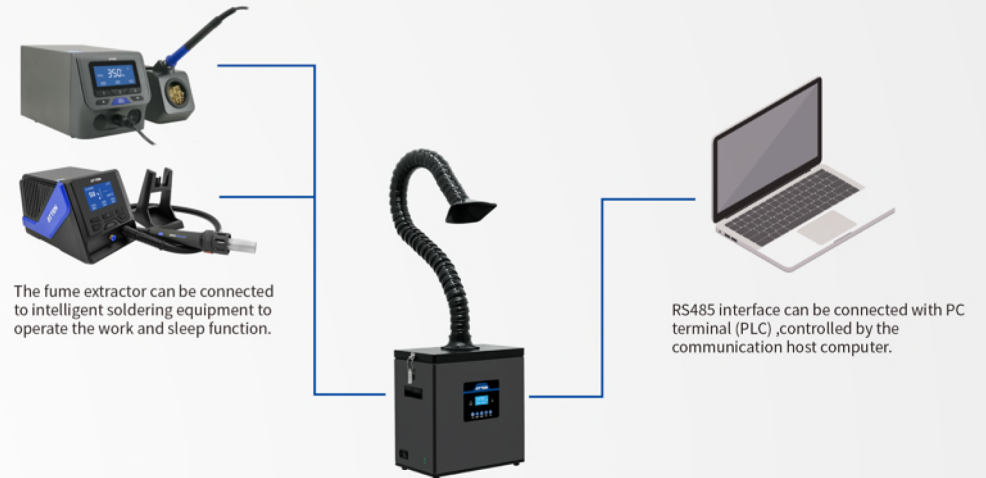

### Connection mode with PC

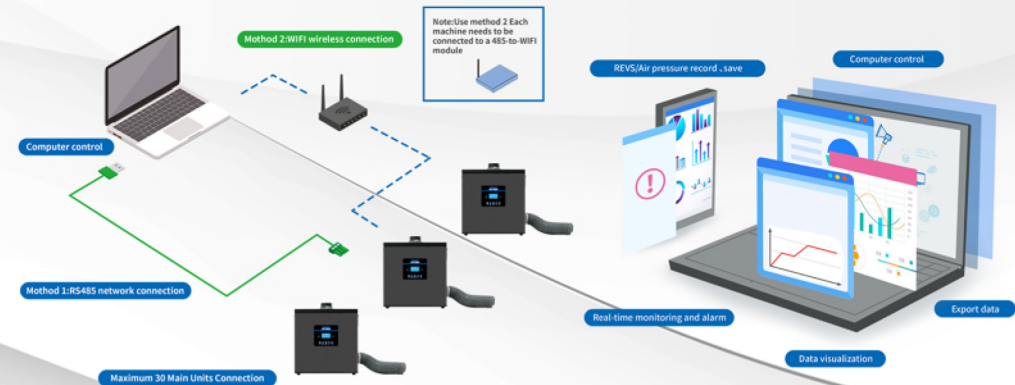

Packed with roller and machine foot pads, which can be installed as needed.

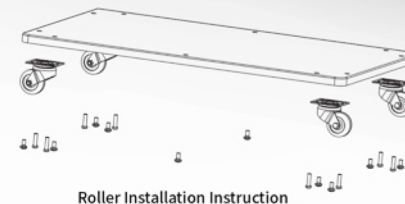

# ST-1101/ST-1202 SMOKE PURIFY MACHINE



- High power motor
- Noise reduction design
- Brushless fan
- Quick replacement of three filters

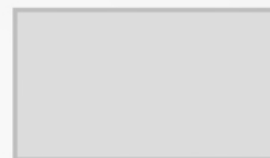

PRE-FILTER



MIDDLE FILTER

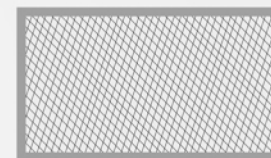

MAIN FILTER

1. The relatively dense side of the pre-filter faces down.
2. The sequence of filters shall be subject to right diagram. Disorganization is strictly forbidden.
3. Suggestions on replacement cycle of filters:
  - a. PRE-FILTER 10-15 days
  - b. MIDDLE FILTER 3-6 months
  - c. MAIN FILTER 6-9 months

(Remark: The actual replacement cycles of filters shall be subject to the pollution levels of different sites.)

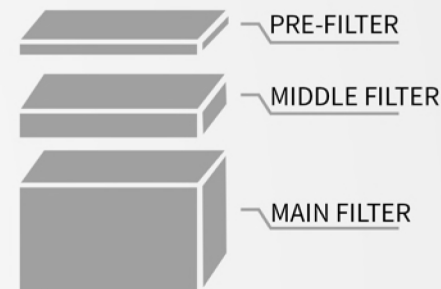

## TEST REPORT

Item No	ST-1101	ST-1202
Voltage	230V	230V
Power	160W	180W
Work positions	1	2
Air Flow	240m <sup>3</sup> /H (± 10%)	150m <sup>3</sup> /H*2 (± 10%)
Filtration efficiency (0.3micron)	99.97%	99.97%
Dimension	465x250x480mm	465x250x480mm
N.W.	17kg	18.2kg



(ST-1101 and ST-1202 has no standard roller)

检测报告									
Report No. WTD20200408002CH									
1. 工作场所空气检测结果									
2. 工作场所粉尘在空气中的workplace									
序号 Point	检测地点/位置 Testing Location/Position	检测项目 Testing Item			检测结果/Range of Experimental		判定标准/Range of Competition/Experiment Limit		
		粉尘 Dusts	游离SiO <sub>2</sub> Free SiO <sub>2</sub>	CaSi	CaSi	CaSi	PC/TWTA	PC/ATEL	MAC
1	李俊良点 李俊良点 Before the time pulper is started on	粉尘 (Other dust)	—	—	—	—	2	—	—
		游离SiO <sub>2</sub> (Free SiO <sub>2</sub> )	—	—	—	—	2	—	—
		李俊良点 (The time pulper is started on)	—	—	0.00	0.00	—	0.09	—
		李俊良点 (The time pulper is started on)	—	—	0.04	8	—	24	—
2	李俊良点 李俊良点 Before the time pulper is started on	粉尘 (Other dust)	—	—	—	—	2	—	—
		游离SiO <sub>2</sub> (Free SiO <sub>2</sub> )	—	—	—	—	2	—	—
		李俊良点 (The time pulper is started on)	—	—	0.00	0.00	—	0.09	—
		李俊良点 (The time pulper is started on)	—	—	0.04	8	—	24	—
3	李俊良点 李俊良点 The time pulper Exhaust Port	粉尘 (Other dust)	—	—	—	—	2	—	—
		游离SiO <sub>2</sub> (Free SiO <sub>2</sub> )	—	—	—	—	2	—	—
		李俊良点 (The time pulper Exhaust Port)	—	—	0.01	2	—	8	—
		李俊良点 (The time pulper Exhaust Port)	—	—	0.03	0.03	—	0.09	—

编号: WT2022040800026131	检测报告
Report No. WY2022040800026131	
***Maximum exposure concentration***	
(4) PC-TWA: 未检出(检出限为 0.01 mg/m <sup>3</sup> )	
(5) PC-TWA: possible short-term exposure limit (weight-weight)	
(6) PC-TWA: 未检出(检出限为 0.01 mg/m <sup>3</sup> )	
(7) PC-TWA: possible short-term exposure limit (weight-weight after adjustment)	
(8) PC-TWA: 未检出(检出限为 0.01 mg/m <sup>3</sup> )	
(9) PC-TWA: 未检出(检出限为 0.01 mg/m <sup>3</sup> )	
(10) PC-TWA: possible short-term exposure limit (weight-weight)	
(11) PC-TWA: 未检出(检出限为 0.01 mg/m <sup>3</sup> )	
(12) PC-TWA: possible short-term exposure limit (weight-weight)	
(13) PC-TWA: 未检出(检出限为 0.01 mg/m <sup>3</sup> )	
(14) PC-TWA: possible short-term exposure limit (weight-weight)	
(15) PC-TWA: 未检出(检出限为 0.01 mg/m <sup>3</sup> )	
(16) PC-TWA: possible short-term exposure limit (weight-weight)	
(17) PC-TWA: 未检出(检出限为 0.01 mg/m <sup>3</sup> )	
(18) PC-TWA: possible short-term exposure limit (weight-weight)	
(19) PC-TWA: 未检出(检出限为 0.01 mg/m <sup>3</sup> )	
(20) PC-TWA: possible short-term exposure limit (weight-weight)	
(21) PC-TWA: 未检出(检出限为 0.01 mg/m <sup>3</sup> )	
(22) PC-TWA: possible short-term exposure limit (weight-weight)	
(23) PC-TWA: 未检出(检出限为 0.01 mg/m <sup>3</sup> )	
(24) PC-TWA: possible short-term exposure limit (weight-weight)	
(25) PC-TWA: 未检出(检出限为 0.01 mg/m <sup>3</sup> )	
(26) PC-TWA: possible short-term exposure limit (weight-weight)	
(27) PC-TWA: 未检出(检出限为 0.01 mg/m <sup>3</sup> )	
(28) PC-TWA: possible short-term exposure limit (weight-weight)	
(29) PC-TWA: 未检出(检出限为 0.01 mg/m <sup>3</sup> )	
(30) PC-TWA: possible short-term exposure limit (weight-weight)	
(31) PC-TWA: 未检出(检出限为 0.01 mg/m <sup>3</sup> )	
(32) PC-TWA: possible short-term exposure limit (weight-weight)	
(33) PC-TWA: 未检出(检出限为 0.01 mg/m <sup>3</sup> )	
(34) PC-TWA: possible short-term exposure limit (weight-weight)	
(35) PC-TWA: 未检出(检出限为 0.01 mg/m <sup>3</sup> )	
(36) PC-TWA: possible short-term exposure limit (weight-weight)	
(37) PC-TWA: 未检出(检出限为 0.01 mg/m <sup>3</sup> )	