

RoHS COMPLIANT

REV.	ECN NO.	DESCRIPTION	DATE
A		REDRAWN	NOV.02'01
B		MODIFY P/N	MAR.02'11

A

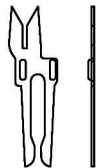
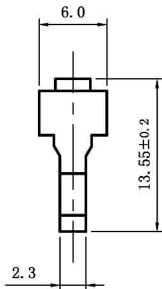
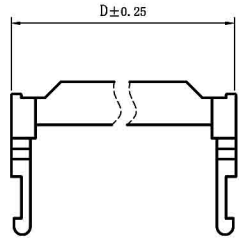

TERMINAL DOUBLE CONTACT

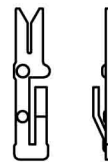

TERMINAL SINGLE CONTACT

Material:
 Insulator: PBT+Glass Fiber (UL94V-0).
 Contact: Copper Alloy.
 Contact Plated: Gold or Tin over Nickel Plated.

Specification:
 Withstanding Voltage: AC 500V for 1 Minute.
 Insulation Resistance: 100 MΩ Min. at DC 500V.
 Contact Resistance: 1 Ω Max..
 Operating Temperature: -40°C — +105°C.

B

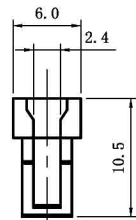
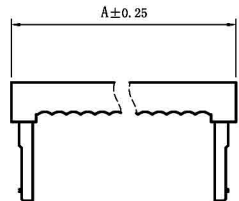

C

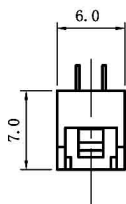
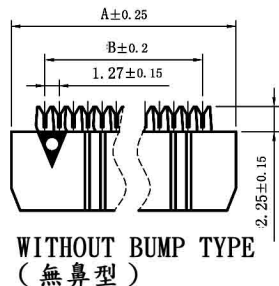

Ordering Information

SC $\frac{**}{a}$ $\frac{*}{b}$ $\frac{*}{c}$ 11 $\frac{-1C}{d}$

- a. No. of Pins
- b. Plating :
G : Gold plating over all.
T : Tin/Gold plating.
- c. Option On Strain Relief
A : With strain relief.
B : Without strain relief.
- d. Contact Type
BLANK : Double contact
1C : Single contact

Pos.	Dim. A	Dim. B	Dim. C	Dim. D	Dim. E
6	12.02	6.35	5.08	12.02	1.9
8	14.50	8.89	7.62	14.50	1.9
10	17.40	11.43	10.16	17.20	3.8
12	19.94	13.97	12.70	19.74	3.8
14	22.48	16.51	15.24	22.28	3.8
16	25.02	19.05	17.78	24.82	3.8
18	27.56	21.59	20.32	27.36	3.8
20	30.10	24.13	22.86	29.90	3.8
24	35.18	29.21	27.94	34.98	3.8
26	37.72	31.75	30.48	37.52	3.8
30	42.80	36.83	35.56	42.80	3.8
34	47.88	41.91	40.64	47.68	3.8
40	55.50	49.53	48.26	55.30	3.8
44	60.58	54.61	53.34	60.38	3.8
50	68.20	62.23	60.96	68.40	3.8
60	80.90	74.93	73.66	80.70	3.8
64	85.98	80.01	78.74	85.78	3.8

D

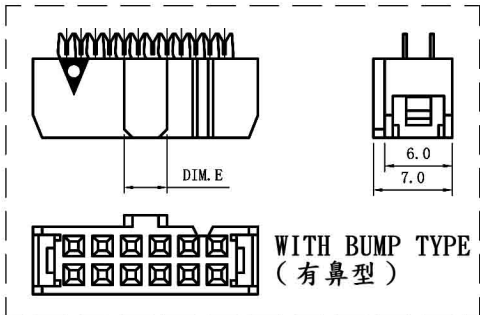
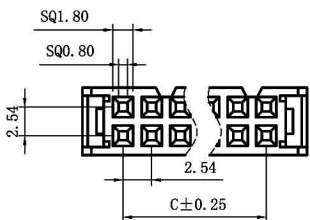

TOLERANCE UNLESS OTHERWISE SPECIFIED		PROJECTION	GOLD-TEK ELECTRIC CO., LTD.
LINEAR	ANGLE		
X. ±	X' ±	UNITS	TITLE
.X ± 0.2	.X' ±	MM [INCH]	IDC SOCKET PITCH: 2.54MM ROW TO ROW 2.54MM
.XX ± 0.10	.XX' ±	SCALE	PART NO.
.XXX ±	.XXX' ±	SIZE	SC****11(-1C)
APPD		A4	CAD NO. 1579
CHKD			F:\PDF\SOC\SOC-0117
DRAW	Z	MAR.02'2011	SHEET 1 OF 1

圖面編號:GTKSD0254-B(1)