

Feature

1. Metal shaft style.
2. Carbon film element.
3. Wide range of resistance tapers.
4. Long Life Type Available.

F16K Series Rotary Potentiometer

Electrical characteristics

- Total Resistance..... $1K\Omega \sim 1M\Omega$
- Total Resistance Tolerance..... $500\Omega < R < 1M\Omega : \pm 20\%$
 $R \leq 500\Omega$ or $R \geq 1M\Omega : \pm 30\%$
- Resistance Taper.....A,B,C
- Max. Operating Voltage.....Linear Taper B: AC 200V,
Other Tapers: AC 150V
- Rated Power.....Linear Taper B : 0.2W; Other Tapers: 0.1W
- Rotational Noise.....Less than 100mV
- Insulation Resistance.....More than $100M\Omega$ at DC 500V
- Withstand Voltage.....1 minute at AC 500V
- Residual Resistance.....Term. 1~2: Less than 20Ω
Term. 2~3: Less than 20Ω
- Gang Error(Dual Unit).....-40dB~0dB $\pm 3dB$

Mechanical characteristics

- Total Rotational Angle..... $300^\circ \pm 5^\circ$
- Rotational Torque.....20gf.cm~100gf.cm
- Stopper Strength.....7.0Kgf.cm Min.
- Push-Pull Strength.....8.0Kgf Min
- Click Torque.....100~300gf.cm
- Bushing & Nut Tight Strength.....8Kgf.cm Min

Switch characteristics

- Switch Circuit.....S.P.S.T.
- Contact Resistance.....Less than $50m\Omega$
- Rated Power.....Single Unit : 1.0 A at AC/DC 12V
- Rotational Angle..... $35^\circ \pm 10^\circ$
- Switch Torque.....70 ~250 gf.cm.
- Switch Life.....15,000 Cycles.

Durability

- Rotational Life.....Standard life: 15,000 Cycles Min.
Long life: 1,000,000 Cycles Min.
- Operating Temperature Range..... $-10^\circ C \sim +70^\circ C$

Note 2: Full C.C.W position

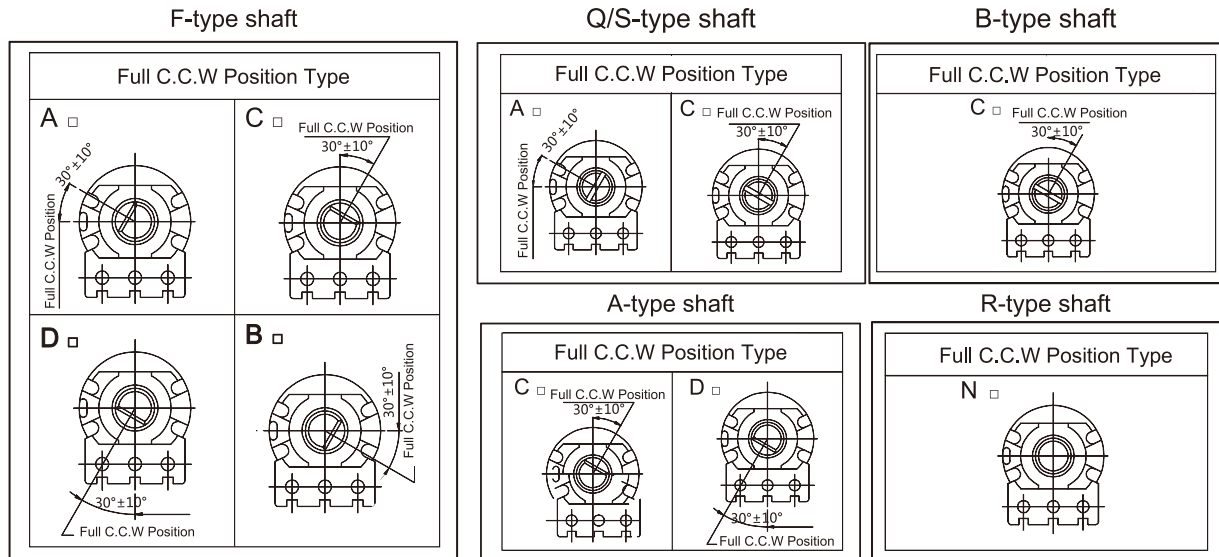

Note 3: Terminal Configuration

V-TYPE

P-TYPE

D-TYPE

H-TYPE

Single Gang:

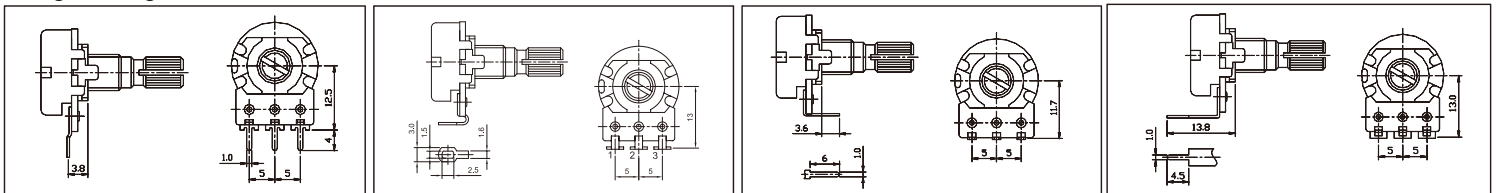

Dual Gang:

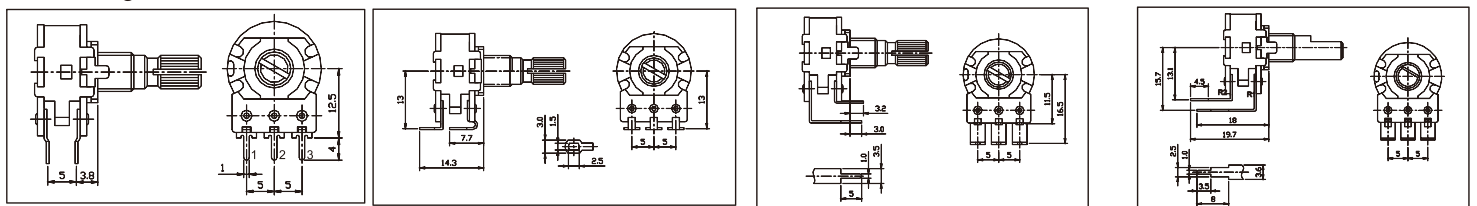

Single Gang with Rotary Switch: (Switch Terminal at Bottom)

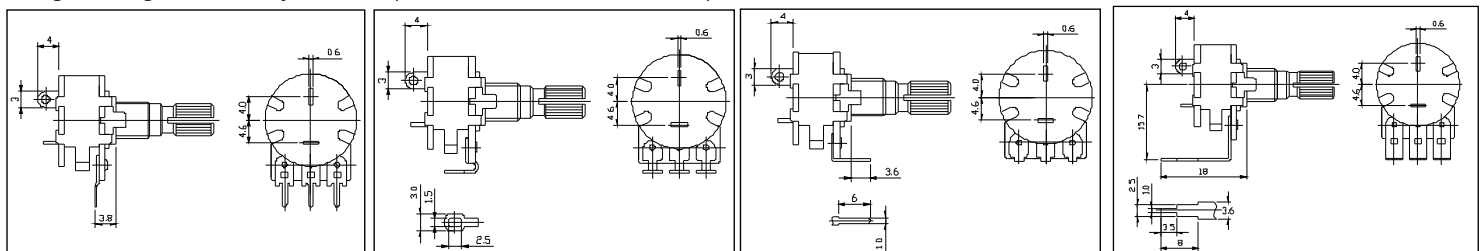

Single Gang with Rotary Switch: (Switch Terminal at Side)

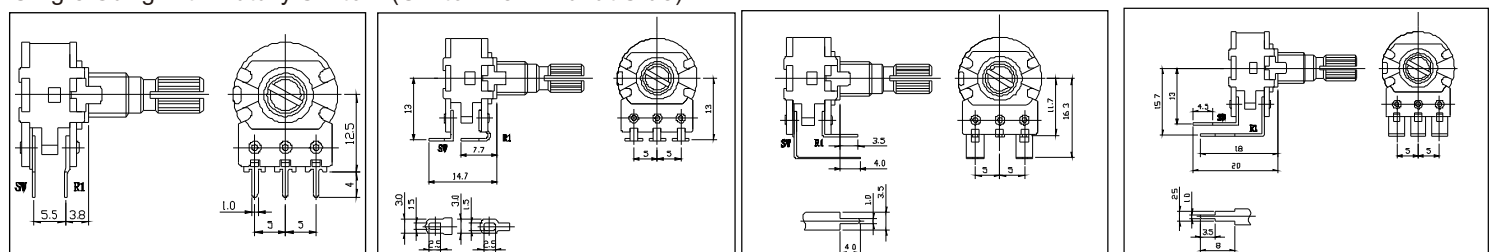

F16K-GV□Q□ Dual Gang, Side Adjust, PC Pins, Q-type Shaft

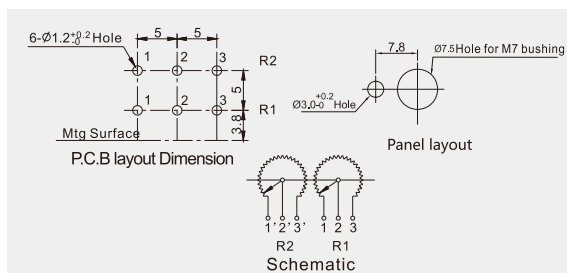
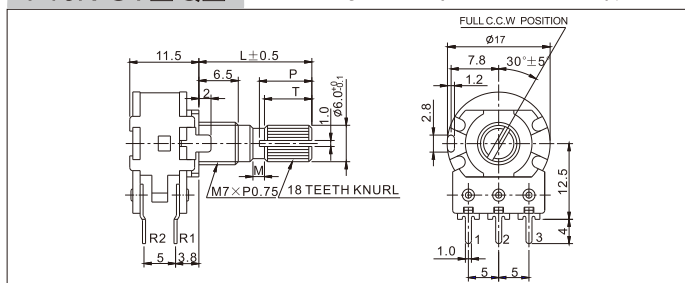

F16K-NV□Q□ Single Gang, Side Adjust, PC Pins, Q-type Shaft

