



ETONM MOTOR

# ET-PGM22 SERIES

ETONM MOTOR CO.,LIMITED

Tel:0086-755-84019605 Fax:0086-755-84019785

Http://www.etonm.com info@etonm.com

MODEL NO.	ET-PGM22B-12406	SAMP. NO	20191019004	CUST. CODE	C180123	VERSION	A
-----------	-----------------	----------	-------------	------------	---------	---------	---

UNIT:MM

## DIRECTION OF ROTATION

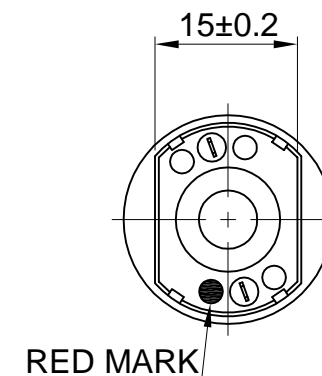
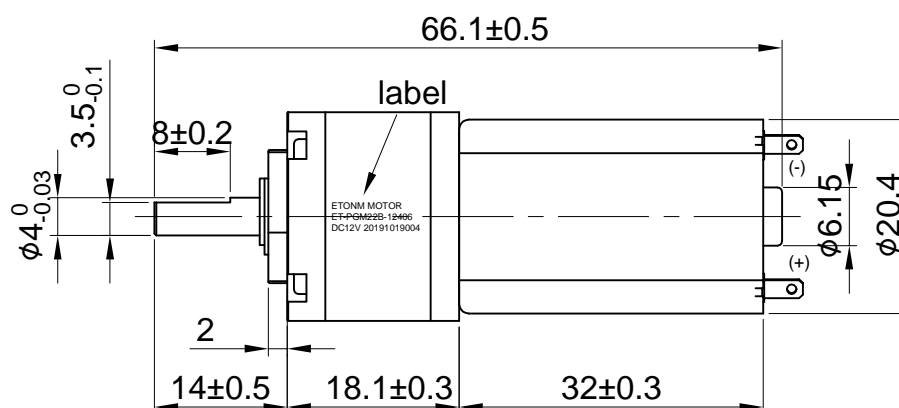
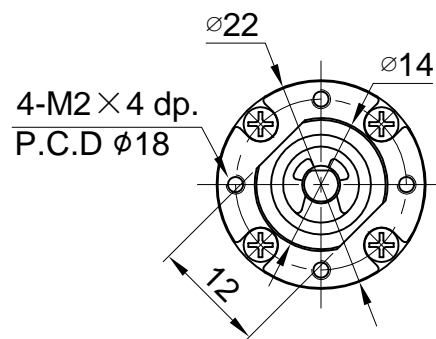

Shaft End Play: 0.05-0.5mm

WEIGHT: 68g (APPROX)

### TESTING CONDITIONS

1. AT RATED VOLTAGE: 12.0VDC (OPERATING RANGE: 6.0~12.0VDC)
2. AT 25±5°C TEMPERATURE AND 60±20% HUMIDITY (OPERATION RANGE: -10°C~+60°C)
3. INSPECTION AFTER 30 SECONDS RUNNING

### NO LOAD

1. NO LOAD CURRENT: 0.12A max
2. NO LOAD SPEED: 390±10%rpm

### ON LOAD

1. ON LOAD TORQUE: 0.25kg.cm
2. ON LOAD CURRENT: 0.24A max
3. ON LOAD SPEED: 310±10%rpm

### AT STALL

(EXTRAPOLATED)

1. STALL CURRENT: 0.82A max

### Notes:

1. Please do the Soldering work in 2 seconds with the soldering-iron Tip at 340~400°C.
2. Do not shock or drop the motor onto ground during mounting process.
3. It is necessary to be careful that any adhesive or glue shall not spread into gearbox shaft along the shaft.

REV	DATE	DESCRIPTION	BY
A	2019.10.24	First edition issued.	YI
APPROVED BY CUSTOMER			
DATE:			

DRAWN	GUANGRONGTANG	REVIEWED	JIHONG YI	APPROVED	YAN YANG	DATE	2019-10-24
-------	---------------	----------	-----------	----------	----------	------	------------