

<b>ENGINEERING DEPT.</b>		<b>PRODUCT SPECIFICATION</b> For CP35 Single Row Series Power Connector	<b>SPEC.NO.:</b>	<b>SPCP044B</b>
<b>REVISIONS</b>	<b>ECN13008-0</b>		<b>PAGE:</b>	<b>1/6</b>

1. SCOPE:

This specification contains the test requirement of subject connectors when tested under the condition and procedure with terminals crimped on the specified maximum size wire

2. APPLICABLE STANDARDS:

MIL - STD - 202	Methods for test of connectors for electronic equipment
MIL - STD - 1344	Test methods for electrical connectors
J-STD-020	Resistance to soldering Temperature for through hole Mounted Devices
SS-00254	Test methods for electronic components ,LEAD-FREE soldering Part design standards

3. APPLICABLE SERIES NO.: CP35 Single Row Series

4. SHAPE, CONSTRUCTION AND DIMENSIONS

See attached drawings

5. MATERIALS

See attached drawings

6. ACCOMMODATED P.C.BOARD

6.1 Thickness: 1.6 mm (.063")

6.2 P.C. Board Layout: See attached drawings



REVIEWED : David APPROVED : Eisley VERIFIED : Steven .

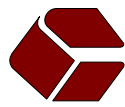

<b>ENGINEERING DEPT.</b>		<b>PRODUCT SPECIFICATION</b> For CP35 Single Row Series Power Connector	<b>SPEC.NO.:</b>	<b>SPCP044B</b>
<b>REVISIONS</b>	ECN13008-0		<b>PAGE:</b>	<b>2/6</b>

7. ELECTRICAL PERFORMANCE:

	ITEM	TEST CONDITION	REQUIREMENT		
7.1	Rated voltage(max.)		600V AC (r.m.s.)		
	Rated Current(max.) and Applicable Wire (Wire-to-Board)	Circuits/Wire gage	2	3-6	7-12
		AWG#20 wire gage	7.0A	5.5A	5.0A
		AWG#22 wire gage	6.0A	4.5A	4.0A
		AWG#24 wire gage	5.5A	4.5A	3.5A
		AWG#26 wire gage	4.5A	4.0A	3.5A
		AWG#28 wire gage	4.0A	3.0A	3.0A
		AWG#30 wire gage	3.5A	3.0A	2.5A
	Rated Current(max.) and Applicable Wire (Wire-to-Wire)	Circuits/Wire gage	2	3-6	7-12
		AWG#20 wire gage	6.5A	5.0A	4.5A
		AWG#22 wire gage	5.5A	4.0A	3.5A
		AWG#24 wire gage	5.0A	4.0A	3.0A
		AWG#26 wire gage	4.0A	3.0A	2.5A
		AWG#28 wire gage	3.0A	2.0A	2.0A
		AWG#30 wire gage	3.0A	2.0A	2.0A
7.2	Contact resistance	Dry circuit of DC 20mV max. , 100mA max., Wire resistance shall be removed from the measured value.	Less than 10 mΩ		
7.3	Dielectric strength	When applied AC 1500 V 1 minute between adjacent terminal	No Breakdown		
7.4	Insulation resistance	When applied DC 500 V between adjacent terminal or ground	More than 1000 MΩ		
7.5	Contact resistance on Crimped portion	Crimp the wire to the terminal, measure by dry circuit, 20mV max., 100mA max., Wire resistance shall be removed from the measured value.	Less than 5 mΩ		

8. MECHANICAL PERFORMANCE:

	ITEM	TEST CONDITION	REQUIREMENT
8.1	Wire size	Specified wire size	Accepts AWG #20-#30



<b>ENGINEERING DEPT.</b>		<b>PRODUCT SPECIFICATION</b> For CP35 Single Row Series Power Connector	<b>SPEC.NO.:</b>	<b>SPCP044B</b>
<b>REVISIONS</b>	ECN13008-0		<b>PAGE:</b>	<b>3/6</b>

	ITEM	TEST CONDITION	REQUIREMENT
8.2	Terminal crimp strength	When crimped AWG#20 size wire	More than 7.0 Kgf
		When crimped AWG#22 size wire	More than 5.0 Kgf
		When crimped AWG#24 size wire	More than 3.0 Kgf
		When crimped AWG#26 size wire	More than 2.0 Kgf
		When crimped AWG#28 size wire	More than 1.2 Kgf
		When crimped AWG#30 size wire	More than 0.8 Kgf
8.3	Terminal insertion force	Insertion speed 25± 3 mm per minute into housing	Less than 1.5 Kgf
8.4	Terminal retaining force in insulator	Retention speed 25± 3 mm per minute from Wire to Wire Housing	More than 2.5 Kgf
8.5	Single contact insertion force	Measure force to insertion using mating square pin at speed 25± 3 mm per minute	700 gram max.
8.6	Single contact withdrawal force	Measure force to withdrawal using mating square pin at speed 25± 3 mm per minute	275 gram min.
8.7	Pin retention force in Board mount Header	Push Pin for insulator base at speed 25± 3 mm per minute	More than 1.4 Kgf
8.8	Durability	Connector shall be subjected to 30 cycles of insertion and withdrawal	Contact resistance: Less than twice of initial
8.9	Locking force	While with drawing plug & receptacle without terminal at speed 25± 3 mm per minute	More than 7.00 Kgf

#### 8.10 Insertion Force and Withdrawal Force :

##### 8.10.1 Test method:

Housing with crimped contacts and a header shall be mated and unmated on the same axis. Initial insertion and withdrawal forces and withdrawal force at 30<sup>th</sup> shall be measured for single circuit and multi-circuits. For the measurement of single circuit, the housing lock shall be removed.



<b>ENGINEERING DEPT.</b>		<b>PRODUCT SPECIFICATION</b> For CP35 Single Row Series Power Connector	<b>SPEC.NO.:</b>	<b>SPCP044B</b>
<b>REVISIONS</b>	ECN13008-0		<b>PAGE:</b>	<b>4/6</b>

8.10.2 Requirements:

**Unit: Kgf**

NO. OF CIRCUITS	INSERTION FORCE Max.)	WITHDRAWAL FORCE (Min.)
2	1.63	0.75
3	2.45	1.13
4	3.26	1.51
5	4.08	1.89
6	4.89	2.26
7	5.71	2.64
8	6.52	3.02
9	7.34	3.39
10	8.15	3.77
11	8.97	4.15
12	9.79	4.53

9. ENVIRONMENTAL PERFORMANCE:

	ITEM	TEST CONDITION	REQUIREMENT
9.1	Temperature rise	Then carried the rated current	30°C max.
9.2	Vibration	1.5 mm 10-55-10 HZ/minute each 2 hours for X, Y and Z directions	Appearance: No damage Discontinuity: 1 micro second max.
9.3	Heat aging	105± 2°C, 96 hours	No damage
9.4	Humidity	60± 2°C, 90-95% RH, 96 hours measurement must be taken within 30 min. after tested	Appearance: No damage Contact resistance: Less than twice of initial Dielectric strength: To pass para 7-3
9.5	Temperature cycling	One cycle consists of : (1) -55 +0/-3 °C , 30 min. (2) Room temp. 10-15 min. (3) 105 +3/-0 °C , 30 min. (4) Room temp. 10-15 min.	Appearance: No damage Contact resistance: Less than twice of initial



<b>ENGINEERING DEPT.</b>		<b>PRODUCT SPECIFICATION</b> For CP35 Single Row Series Power Connector	<b>SPEC.NO.:</b>	<b>SPCP044B</b>
<b>REVISIONS</b>	ECN13008-0		<b>PAGE:</b>	<b>5/6</b>

	ITEM	TEST CONDITION	REQUIREMENT
9.6	Salt spray	Temperature: 35± 3°C Solution: 5± 1% Spray time: 48± 4 hours Measurement must be taken after water rinse	Appearance: No damage Contact resistance: Less than twice of initial
9.7	Solder ability	<b>Lead-Free Process:</b> Soldering time: 3 ± 0.5 second Soldering pot: 245 ± 5°C	Minimum: 90% of immersed area
9.8	Resistance to soldering heat	<b>DIP Type Lead-Free Process</b> Soldering time: 5 ± 0.5 second Soldering pot: 260 ± 5°C <b>SMT Type Lead-Free Process:</b> Soldering time: 20 second Max. Soldering pot: 250~260°C Refer Reflow temperature profile(11.2)	No damage

10. AMBIENT TEMPERATURE RANGE: -40 to + 105°C

11. Recommended IR Reflow Temperature Profile:

11.1 Using Typical Solder Paste

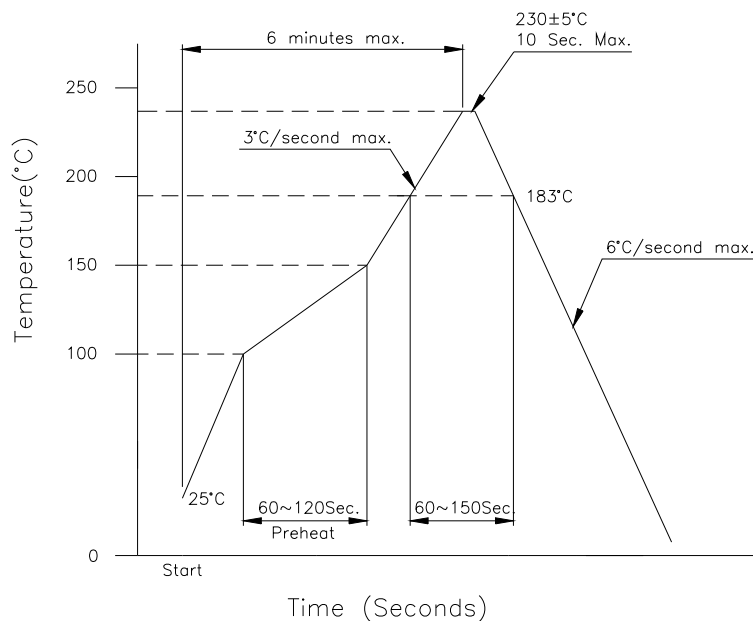

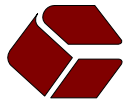

<b>ENGINEERING DEPT.</b>		<b>PRODUCT SPECIFICATION</b> For CP35 Single Row Series Power Connector	<b>SPEC.NO.:</b>	<b>SPCP044B</b>
<b>REVISIONS</b>	<b>ECN13008-0</b>		<b>PAGE:</b>	<b>6/6</b>

### 11.2 Using Lead-Free Solder Paste

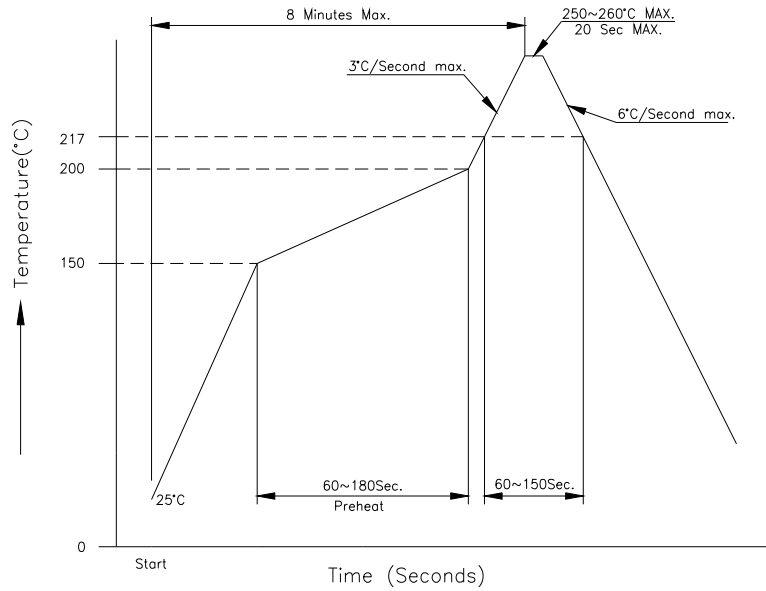

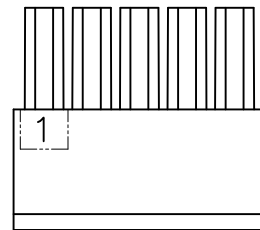
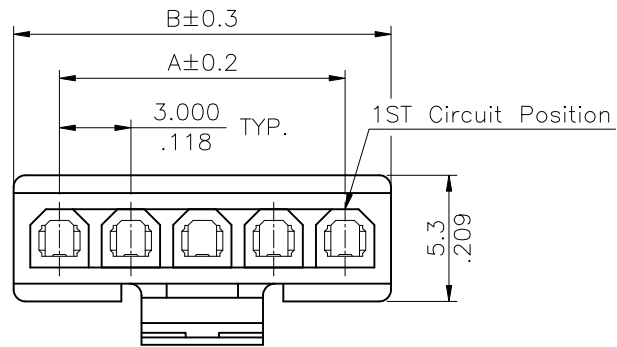

BACK VIEW

Material : Nylon66 UL 94V-0

Ordering Code:

CP35 \*\* S 001 S -NH  
 ① ② ③ ④ ⑤ ⑥

- ① Series No.
- ② Connector: 02 to 12
- ③ Contact type: S = Receptacle
- ④ Color: 001 = Color Black
- ⑤ Option: S= Single Row
- ⚠ ⑥ -NH= Halogen-Free

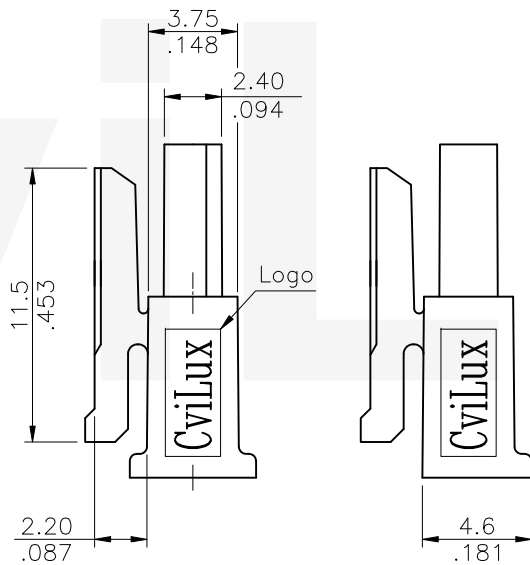
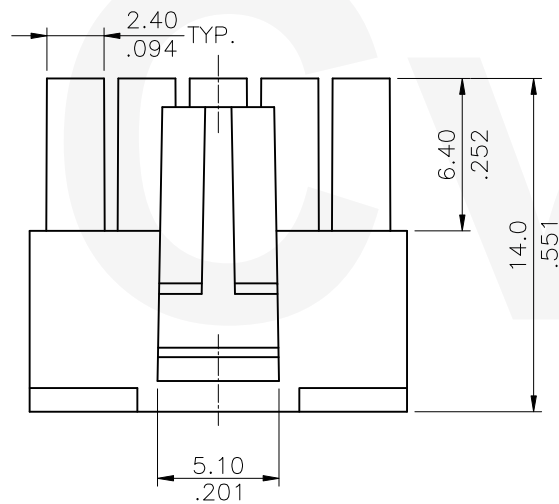

Other Circuits

2 Circuits

Circuits	Dimension	
	A	B
2	3.00(.118)	6.9(.272)
3	6.00(.236)	9.9(.390)
4	9.00(.354)	12.9(.508)
5	12.00(.472)	15.9(.626)
6	15.00(.591)	18.9(.744)
7	18.00(.709)	21.9(.862)
8	21.00(.827)	24.9(.980)
9	24.00(.945)	27.9(1.098)
10	27.00(1.063)	30.9(1.217)
11	30.00(1.181)	33.9(1.335)
12	33.00(1.299)	36.9(1.453)

Halogen-Free

RoHS Compliant

**CVILUX CORP**  
 2019.07.05  
 ISSUED

SYM	NAME	DATE	REVISIONS	APPROVED BY:	DATE	UNIT: mm / inch	TITLE: 3.00mm PITCH POWER CONNECTOR FEMALE HOUSING
④						TOLERANCE UNLESS OTHERWISE SPECIFIED	MATERIAL:
③							
②						.X ±0.30/.012 X' ± 1'	CUSTOMER: TCF0012
①	Sandy	6/11-19'	ECNT119143	Eisley	7/04-19'		
				Eisley	7/04-19'	.XXX ±0.10/.004 XX' ±	



瀚荃股份有限公司  
 CviLux Corporation

DRAWING NO.	CP3512AB	PART NO.	CP35**S001S-NH
SCALE	3 / 1	SHEET	1 OF 1