

Data Sheet

Type Number	6450
Designation IEC	CR 2450
System	Li-Manganese dioxide / Organic Electrolyte
UL Recognition:	MH 13654
Nominal Voltage	3 V
Typical Capacity C	590 mAh
Load 5.6 kOhm, at 20°C down to 2 V	
Weight (approx.)	6,2 g
Volume	2,3 ccm
Coding	Date of Manufacturing Month/Year

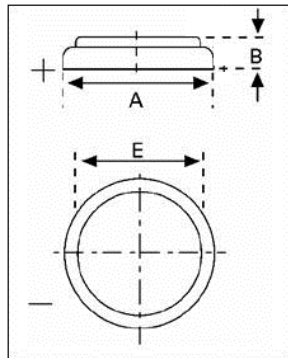

Temperature Ranges	min	max.
Storage	-55°C	70°C
Discharge	-40°C	85°C*

Dimensions	min	max.
Diameter (A)	24,2	24,5
Height (B)	4,6	5,0
Shoulder Diameter (E)		

Segment Electronic

Main Applications Watch
Photo
Electronic

Typical Capacities (at 20°C)

Discharge Type	Load	End Voltage:	2.0 V
Continuous 24h/d,7d/w	5600 Ω	Time:	1175 h
		Capacity [mAh]:	590
		Energy [mWh]:	1640

* Contact VARTA if the application is intended to be outside the range of -20°C to 70°C.

*Information and contents in this data sheet are for reference purpose only.
They do not constitute any warranty or representation and are subject to change without notice.
For most current information and further details, please contact your VARTA representative.*

Data Sheet

Performance Data:

● **Temperature Characteristics***

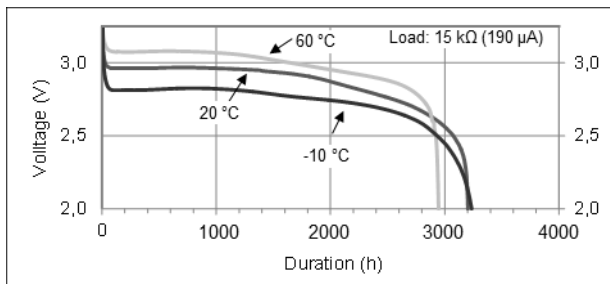

● **Operating Voltage vs. load resistance***

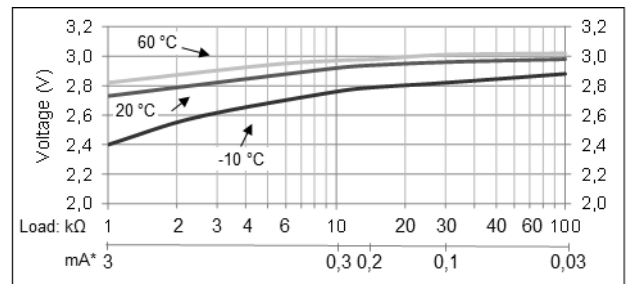

● **Capacity vs. load resistance**

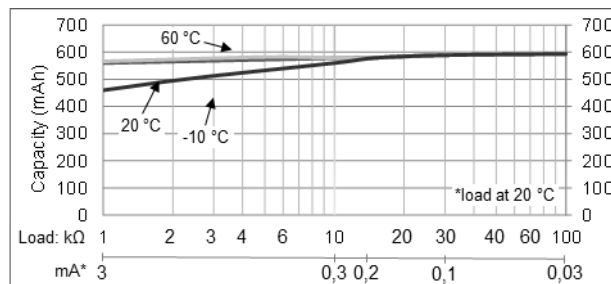

- Self-discharge rate < 1% at room temperature
- Storage life > 10 years
- Operating life* > 10 years

* depending on environmental condition and energy consumption

*Information and contents in this data sheet are for reference purpose only.
They do not constitute any warranty or representation and are subject to change without notice.
For most current information and further details, please contact your VARTA representative.*