

1

2

3

4

5

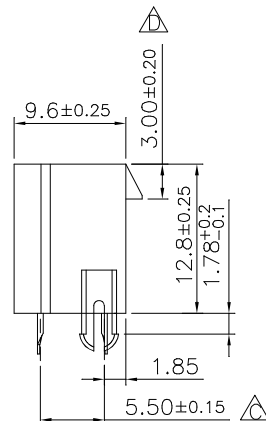
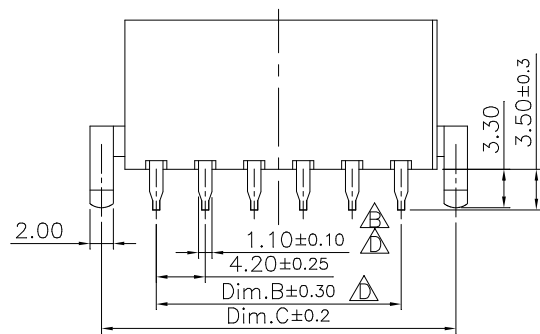
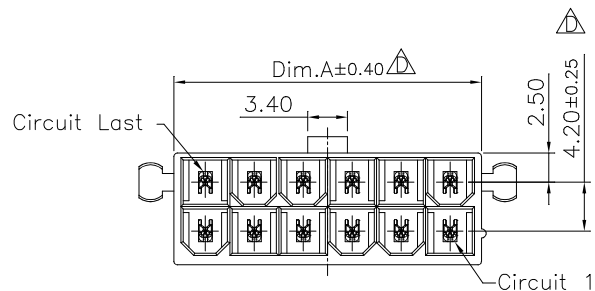

Dimension Information:

Pos.	Dim A	Dim B	Dim C	Circuits	Dim A	Dim B	Dim C
2	5.4	—	9.4	14	30.6	25.2	34.6
4	9.6	4.2	13.6	16	34.8	29.4	38.8
6	13.8	8.4	17.8	18	39.0	33.6	43.0
8	18.0	12.6	22.0	20	43.2	37.8	47.2
10	22.2	16.8	26.2	22	47.4	42.0	51.4
12	26.4	21.0	30.4	24	51.6	46.2	55.6

## Specifications:

Current Rating: 9.0A AC/DC  
 Voltage Rating: 600V AC/DC  
 Contact Resistance: 10m ohm. Max.  
 Insulation Resistance: 1000M ohm. Min.  
 Withstanding Voltage: 1500V AC For One Minute  
 Operating Temperature Range: -40°C To +105°C

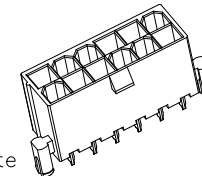

## Materials:

Insulator: Nylon 66 (UL94V-2; UL94V-0)  $\triangle$   
 Insulator Color: Natural or Black or Ivory  $\triangle$  $\triangle$   
 Contact: Brass  
 Plating: Tin Plated or Gold Plated  $\triangle$

## How To Order:

$\triangle$  2266S-XXX-PG-XX-VX-XX

- Blank Halogen
- HF: Halogen-Free
- F4A: Meet The GWT (Ivory)  $\triangle$  $\triangle$
- Blank V2 Material (Transparent)
- V0: V0 Material (White)
- Blank Natural
- BK: Black  $\triangle$
- PG: With Peg
- Blank Tin Plated
- G: Gold Plated
- No. of Contacts
- S: Straight Type Double Row

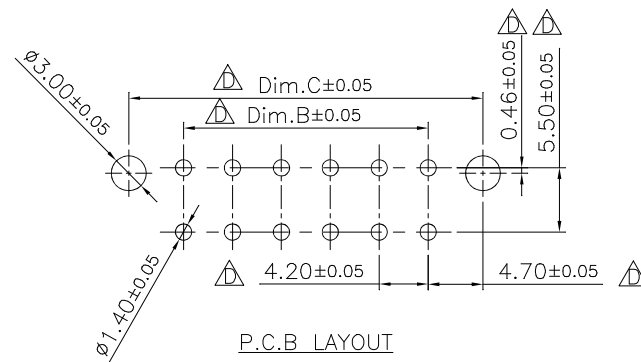

RoHS Compliant

G	19-DEC-2022	Modify Insulator Color	Lucy Du
F	12-NOV-2021	Add F4A&BK Option	Lisy Liu
E	19-OCT-2021	Modify Carton Size	Lisy Liu
D	22-JUN-2020	$\triangle$	Lisy Liu
C	16-NOV-2016	ECN-TW1611001	Jamie Wang
A	06-APR-2007	(PG0001) (P0001)	Andrew
REV	DATE	FILE	BY

DRAWN:	Justin Ho
CHECKED:	Jerry Chen
APPROVAL:	Mike Wu

GENERAL TOLERANCE:	.X = ± 0.40 $\triangle$ .XX = ± 0.30 $\triangle$
UNIT:	MM
SCALE:	
SHEET:	1/3
PROJECTION:	$\oplus$ $\triangle$



# Neltron Industrial Co., Ltd.

DESCRIPTION: 4.2mm Power Wafer Double Rows With Post Straight Type

PART NO: 2266S-XXX-PG-XX-VX-XX  $\triangle$  $\triangle$

SIZE

## A4

D

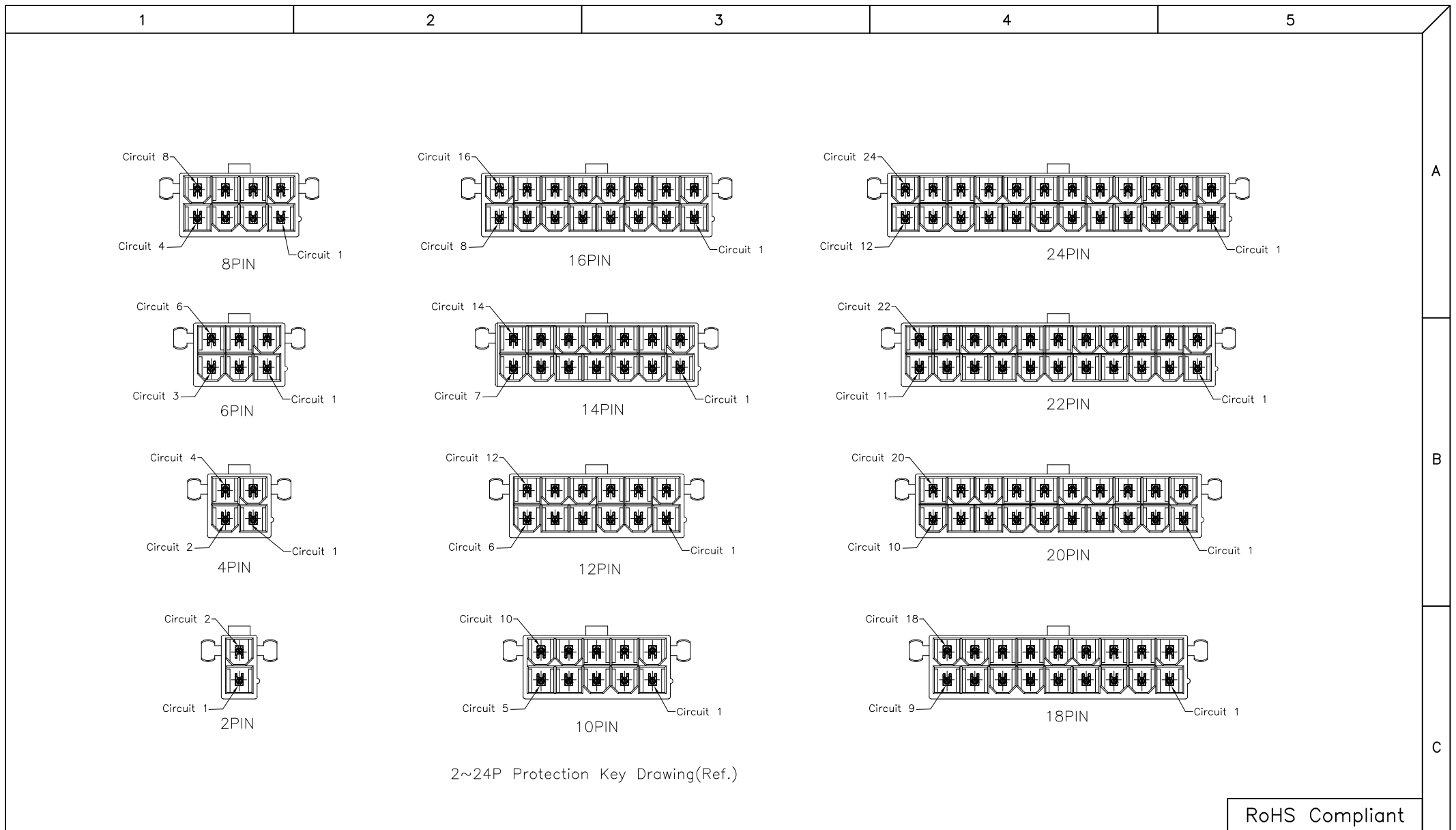

RoHS Compliant

G	19-DEC-2022	Modify Insulator Color	Lucy Du	DRAWN: Justin Ho	GENERAL TOLERANCE: .X=±0.40 .XX=±0.30	<b>Neltron Industrial Co., Ltd.</b>	DESCRIPTION: 4.2mm Power Wafer Double Rows With Post Straight Type	SIZE
F	12-NOV-2021	Add F4A&BK Option	Lisy Liu					
E	19-OCT-2021	Modify Carton Size	Lisy Liu	CHECKED: Jerry Chen	UNIT: MM	PART NO: 2266S-XXX-PG-XX-VX-XX	A4	
D	22-JUN-2020		Lisy Liu		SCALE:			
C	16-NOV-2016	ECN-TW1611001	Jamie Wang	APPROVAL: Mike Wu	SHEET: 2/3			
A	06-APR-2007	(PG0001)- (P0001)	Andrew		PROJECTION:			
REV	DATE	FILE	BY					